



# AERIE

**Affordable, Lightweight, Campers for 3/4 Ton Trucks!**



BUILT TO LAST



# SOARING EAGLE CAMPERS

While a number of truck campers on the market are constructed using a lot of wood, SOARING EAGLE CAMPERS constructs our campers using all-welded, tubular aluminum



and composites, covered by thick, seamless fiberglass exteriors. Even the exterior fiberglass and interior wall and ceiling coverings are backed with a composite material, not thin wood like a lot of others. This attention to detail provides our customers with the

longest lasting, most durable and moisture resistant truck camper possible.

Soaring Eagle Camper's engineers design each camper to be as strong as possible, using not only 1.5" tubes, but also 3" tubes. Our studs are located every 16" on center (minimum). All of this aluminum structure ensures that our camper will stand the test of time as it bounces down the road everyday! The use of 3" tubes, especially in areas where the camper is going to experience the most stress - ensures that our camper can stand up to the rigors of the road for decades - not just a couple of years.



While there are a lot of truck campers on the market that look great on the outside, we encourage customers to look "underneath" all of the bells and whistles to see just how a camper is constructed before they make their purchasing decision. When they do, we are confident that they are going to like what they see in the AERIE truck camper line.

The entire STRUCTURE of the AERIE model is actually wood-free, providing our customers with years of care-free usage along with the best value for their money!



**ENGINEERED AND  
CONSTRUCTED TO STAND  
THE TEST OF TIME.**

**PROVEN TO  
BE ONE OF  
THE BEST  
INSULATED  
CAMPER  
IN  
IT'S CLASS.**

When we say that the AERIE truck camper from SOARING EAGLE CAMPERS is very well insulated - we can prove it! The AERIE earned TRUMA's coveted GOLD STANDARD Certification, their highest honor. This was accomplished after rigorous testing in TRUMA's



famous Climate Chamber where the AERIE camper was "frozen" for ten hours at just 5° (with the windows, vents and door open) which defines the starting point for their testing. At that point, the furnace was turned on with the goal of increasing the temperature inside the camper from 5° to 68° in just four hours.

The AERIE accomplished this in just over 2 hours, passing the test with flying colors and earning high praise from TRUMA's testing team. In fact, after the four hour testing period was completed, the multiple

temperature sensors inside the AERIE recorded the interior temperature at a toasty 82° Fahrenheit, while the basement sensors recorded an even higher temperature level!

The holding tanks and whatever is in storage are sure to be protected from the cold with this amazingly well insulated truck camper.



**ENJOY CAMPING  
WHEREVER  
YOUR TRUCK  
CAN TAKE YOU!**

# AERIE 8



**A TRUE 3/4-TON TRUCK CAMPER THAT WILL NOT OVER LOAD YOUR TRUCK! WEIGHS ONLY 2,300 lbs.!**

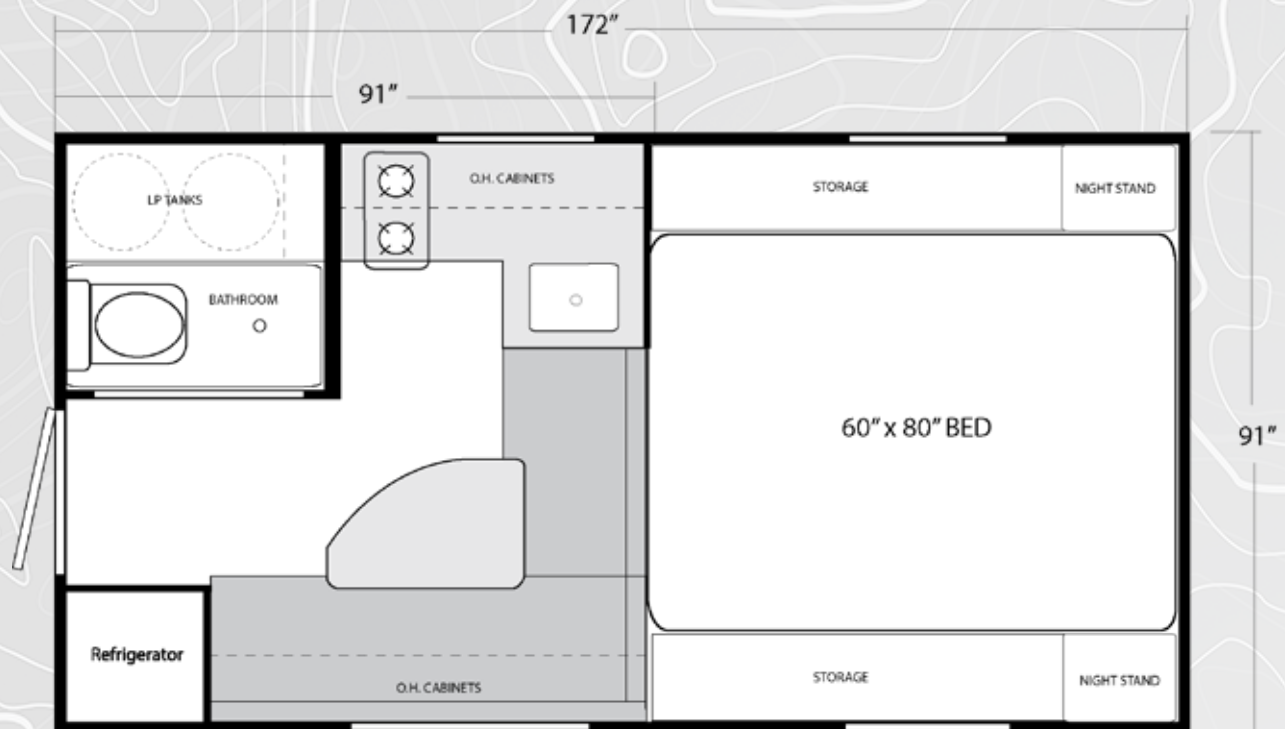

**AERIE 8**

# Go Anywhere - Camp Anywhere!



Load up your gear and GO! In the AERIE, Soaring Eagle Campers has designed a beautiful camper for 3/4 ton truck owners. The overall interior spaciousness afforded by this open, airy interior will surprise you. There is an amazing amount of headroom, along with a roomy L-shaped dinette, full size queen bed with loads of storage, dual nightstands, a kitchen with a two burner range and deep sink, a nice sized 12V refrigerator, microwave/convection/air fryer oven and loads of counter top and storage space. Large dual pane slider windows provide an amazing amount of natural light, as well as great air flow.



# AERIE



## ENJOY THE COMFORTS OF HOME – WHILE ON THE ROAD

The permanent North/South bed in the AERIE features a residential style mattress with memory foam top, providing owners with a supremely comfortable night's sleep. A padded, fabric-covered headboard adds both comfort and style, while the extra head room in the cab-over bed allows you to easily maneuver when getting in or out of the bed. This area now includes a wardrobe for hanging clothes, not shown in the prototype.

There are night stands on both sides of the bed, each featuring 110V outlets and 12V/USB chargers.



**RESIDENTIAL STYLE MATTRESS**



You'll appreciate the long cabinets on both sides of the bed, providing an abundance of storage for all your travel needs.





You will really appreciate all of the extra elbow room that we have designed into the bathroom layout of the AERIE. Highlighted by a herringbone pattern feature wall, this stunning wet bath offers a full 40" by 40" space!

Featuring a high gloss countertop area which now features a sink and mirror (this photo is of the prototype which didn't have those two features) this bathroom was definitely not an afterthought.

The custom-designed composite shower pan with aluminum structure support makes it feel like you are in your home shower instead of being crammed into a closet with a thin plastic floor. A Dometic cassette toilet with ceramic insert swivels to accommodate easy access. This open bathroom concept really enhances the overall spaciousness of the camper and when you need it, the retractable sliding door provides privacy while allowing ventilation over the top.



# AERIE



The roomy wet bath of the AERIE offers unmatched spaciousness with its nearly 40" x 40" footprint. Not shown here, but included with future models is a sink built into the countertop as well as a mirror.



The Dometic™ cassette toilet features a ceramic insert with a black tank capacity of 5 gallons, while the fresh water reservoir is nearly 2 gallons.

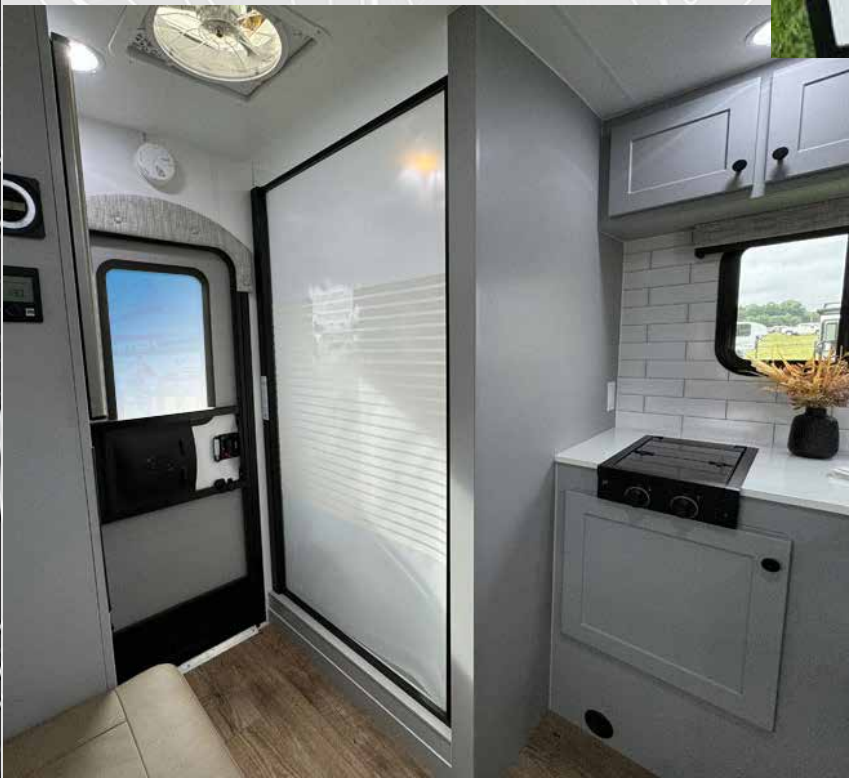

The stylish retractable shower door of the AERIE is very functional, closing off the bathroom from the rest of the coach for privacy while allowing air flow over the top.





The 3.3 cu. ft. 12V refrigerator has multiple storage areas, including in the door, as well as a built-in freezer compartment.

The microwave oven is also a convection oven and air fryer (3 in 1). In production models, this has moved from this location under the refrigerator to the kitchen area under the 2-burner range. The area under the refrigerator will become additional storage.

Not only have we added another inch to the already roomy basement on our production models, we offer an optional MORryde steel slide-out tray to maximize that storage area! You will appreciate this great feature to maximize your storage in the AERIE camper.



# AERIE



## AUTOMOTIVE GRADE FOAM IN THE DINETTE SEATING

These are not your typical truck camper dinette cushions! Soaring Eagle Campers spared no expense in designing the new AERIE camper, including paying to upgrade to automotive grade foam in our luxurious dinette seating. Covered in soft faux leather with elegant stitching and design lines, you will feel like you are sitting on your couch at home, not in a camper.





## AERIE – OFFERING STYLE, FORM, AND FUNCTION!

The all-new AERIE from Soaring Eagle Campers was designed with our customers needs and convenience in mind. This includes designing this camper to fit in the back of most 8' truck beds with the Tailgate CLOSED. Why would we take the time to do this? Why wouldn't we - and every other truck camper manufacturer for that matter?

The tailgate on most modern truck models has amazing features such as built-in steps allowing customers to easily get in and out of their camper; a rear camera which AERIE customers can still utilize while the camper is in their truck; as well as security sensors and other features built into most tailgates. Some ask why we designed our campers this way? Our answer to that is, why doesn't everybody?



## SPECIFICATIONS

Overall Length:	178"
Overall Width:	91"
Interior Height:	6'-8"
Interior Width:	88.5"
Interior Floor Length:	7'-5"
Exterior Floor Width"	91"
Dry Weight	2,300 lbs.
Fresh Water Capacity"	28 Gal.
Gray Water Capacity"	13 Gal.
Cassette Toilet:	5 Gal.
LP Tank:	20 lb. with gauge
Lithium Battery:	100AH w/Bluetooth Heat



## SOARING EAGLE CAMPERS ARE NOT CHEAP.

It's not cheap to build a truck camper using all welded, tubular aluminum framing and composites instead of wood.

It's not cheap to use 3" tubular aluminum in parts of our structure and cover the entire unit with one-piece, seamless fiberglass.

It's not cheap to craft an all-aluminum basement storage area to allow the main floor to expand side to side in the truck.

It's not cheap to put the super-efficient TRUMA Combi furnace and water heater in our camper as Standard in place of a typical RV system.

It's not cheap to use automotive grade foam in our seating and to use a residential style mattress in our bed.

We could make it cheap, but then it wouldn't be a Soaring Eagle Camper!



**SOARING EAGLE CAMPERS**

1025 E. WATERFORD

WAKARUSA, IN 46573

[www.SOARINGEAGLECAMPERS.com](http://www.SOARINGEAGLECAMPERS.com)

Email us at [inquire@soaringeaglecampers.com](mailto:inquire@soaringeaglecampers.com)